

Before you begin...

Clear an open area as large as 2 X the leg length and wider than the beam.

Get a crane or lifting device capable of lifting the entire weight of the completed crane.

Assemble a work crew of no less than three. One will operate the lifting crane and the others perform the assembly.

You may need more to lift the higher capacity legs.

1 Beam & Brackets

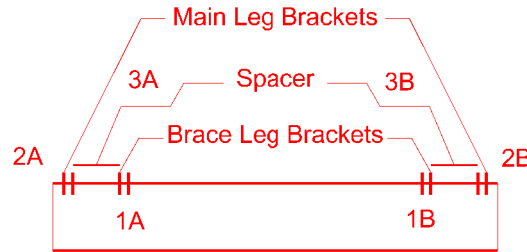

Attach brackets in this order: 1A-B then 2A-B

2 Balance with Legs

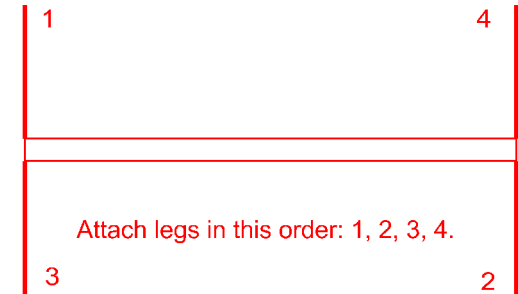

3 Brace Legs

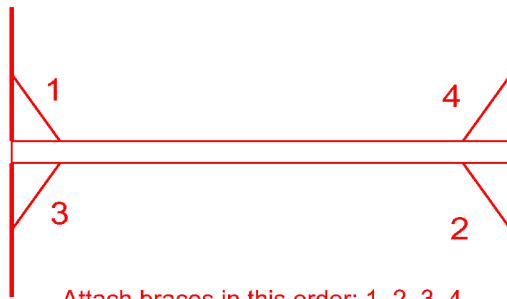

Attach braces in this order: 1, 2, 3, 4.

3 Casters & Caster Frame

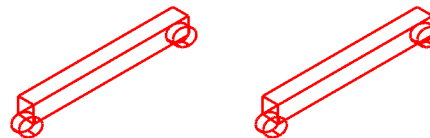

Bolt wheels to frame.
All Bolts must have a lock washer and nut.

4 Beam Up & Build

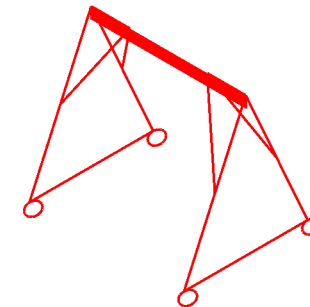

Bolt, Washer, Nut

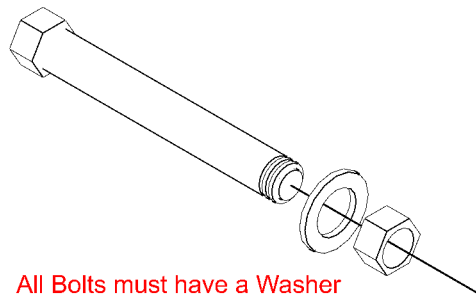

All Bolts must have a Washer (or Lock Washer) and Nut.

All Pins

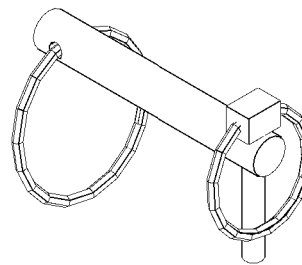

All pins must be fastened on both ends.

- 1 With beam raised, place brackets as shown. Tighten set screws after the legs are on.
- 2 Attach the legs in the order shown to reduce imbalance.
- 3 Main legs and braces can be assembled independently from caster frame .
- 4 Raise the beam, braces, and legs so that the caster frame pins slide in easily.

Quick Instructions do not list all details and do not include all necessary safety precautions. See the applicable instructions for complete information.